

CHICAGO FAUCETS 

a Geberit company

2100 South Clearwater Drive
Des Plaines, IL 60018
Phone: 847-803-5000
Fax: 847-803-5454
www.chicagofaucets.com

REPAIR PARTS

BY: SID DATE: 01-10-08

CHK: *[Signature]* REV: 08-08-11

FITTING NO.

860-CP

SUBMITTED MODEL NO.

ITEM NO.

FOR TECHNICAL ASSISTANCE
1-800-TEC-TRUE (1-800-832-8783)

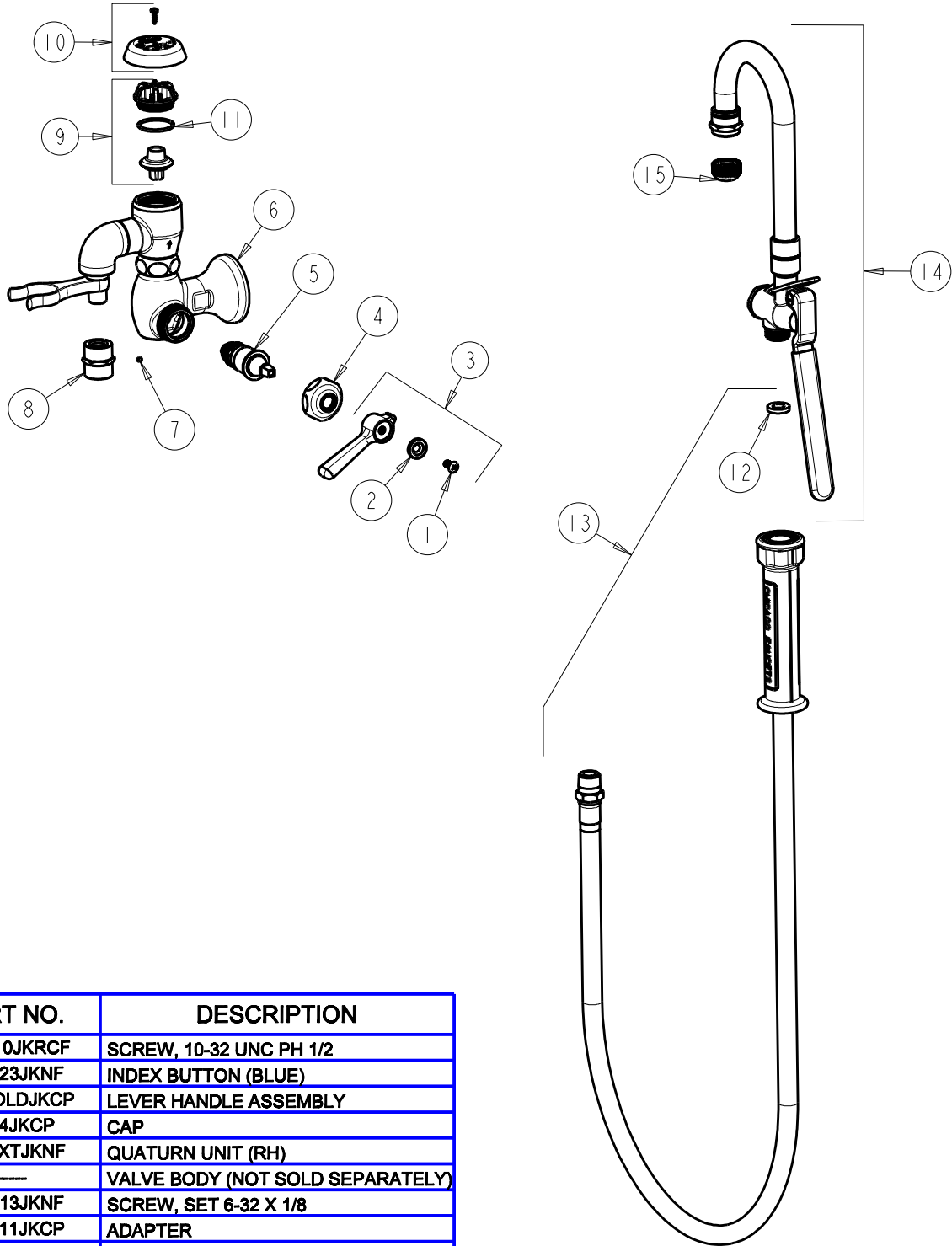

ITEM	PART NO.	DESCRIPTION
1	420-010JKRCF	SCREW, 10-32 UNC PH 1/2
2	633-123JKNF	INDEX BUTTON (BLUE)
3	369-COLDJKCP	LEVER HANDLE ASSEMBLY
4	1-214JKCP	CAP
5	1-099XTJKNF	QUATURN UNIT (RH)
6	---	VALVE BODY (NOT SOLD SEPARATELY)
7	777-013JKNF	SCREW, SET 6-32 X 1/8
8	224-011JKCP	ADAPTER
9	892-302JKNF	VACUUM BREAKER REPAIR KIT
10	892-254JKCP	VACUUM BREAKER COVER w/SCREW
11	80-007JKNF	O RING 0.989 X .070
12	919-243JKNF	GASKET, .685 X .375 X .125
13	83-58NF	58" HOSE AND HANDLE ASSEMBLY
14	90-GNABCP	FOR PARTS SEE 90-GNABCP
15	E1JKABRCF	PLAIN OUTLET WITH SCREEN