

**CHICAGO FAUCETS** 

a Geberit company

2100 South Clearwater Drive  
Des Plaines, IL 60018  
Phone: 847-803-5000  
Fax: 847-803-5454  
www.chicagofaucets.com

# REPAIR PARTS

BY: JAR DATE: 04-06-09  
CHK:  REV:

FITTING NO.

**844-665PSHCP**

SUBMITTED MODEL NO.

ITEM NO.

**FOR TECHNICAL ASSISTANCE**  
**1-800-TEC-TRUE (1-800-832-8783)**

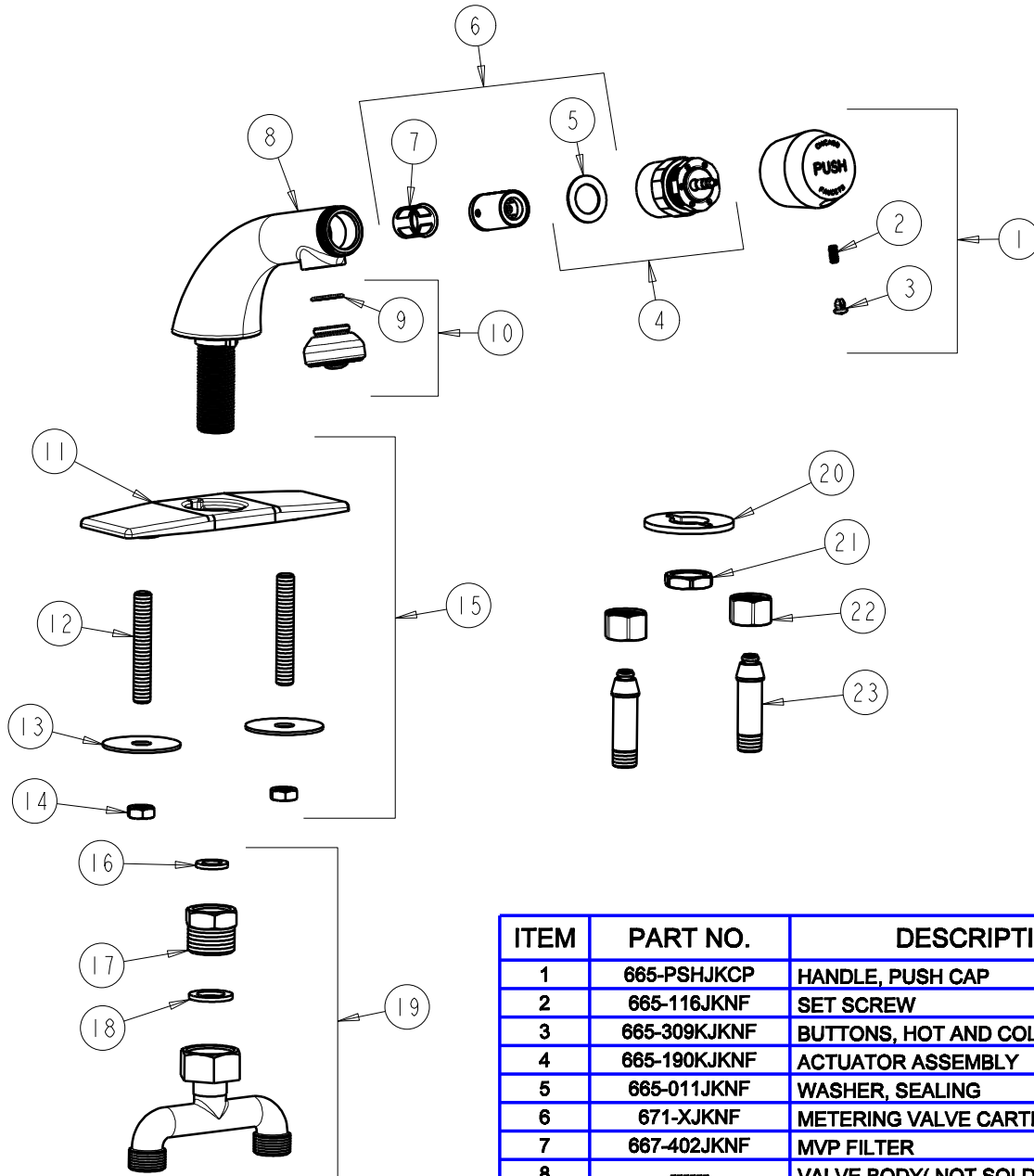

ITEM	PART NO.	DESCRIPTION
1	665-PSHJKCP	HANDLE, PUSH CAP
2	665-116JKNF	SET SCREW
3	665-309KJKNF	BUTTONS, HOT AND COLD
4	665-190KJKNF	ACTUATOR ASSEMBLY
5	665-011JKNF	WASHER, SEALING
6	671-XJKNF	METERING VALVE CARTRIDGE
7	667-402JKNF	MVP FILTER
8	-----	VALVE BODY( NOT SOLD SEPARATELY)
9	1-164JKNF	RUBBER WASHER
10	E15JKCP	ROSE SPRAY OUTLET
11	807-003JKCP	COVER PLATE
12	634-215JKRBF	STUD, 3/8-24 UNF X 2.5
13	634-124JKNF	WASHER, STEEL 1.75 X .43 X .06
14	689-113JKRBF	NUT, 3/8-24 UNF X .56 X .22
15	807-003JKKCP	COVER ASSEMBLY
16	1001-002JKNF	GASKET
17	808-001JKRBF	COUPLING
18	1-143JKNF	SEAT WASHER
19	1-143KJKRBF	CONNECTION ASSEMBLY
20	807-112JKNF	WASHER
21	49-004JKRBF	LOCKNUT
22	49-005JKRBF	COUPLING NUT
23	58-018KJKRBF	TAILPIECE