



a Geberit company

2100 South Clearwater Drive
Des Plaines, IL 60018
Phone: 847-803-5000
Fax: 847-803-5454
www.chicagofaucets.com

REPAIR PARTS

BY: JAR DATE: 11-27-13

CHK: *[Signature]* REV: 06-25-14

FITTING NO.

1301-SBJKCP

SUBMITTED MODEL NO.

ITEM NO.

FOR TECHNICAL ASSISTANCE
1-800-TEC-TRUE (1-800-832-8783)

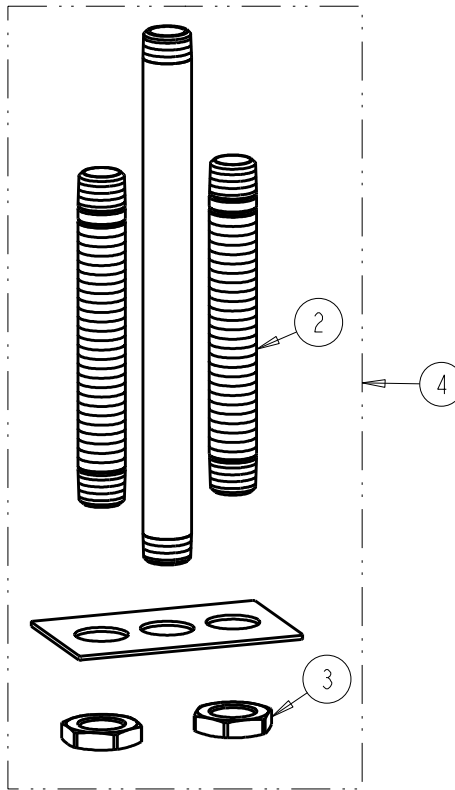
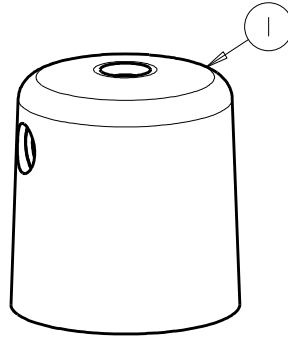

ITEM	PART NO.	DESCRIPTION
1	-----	TURRET
2	957-003JKABRBF	MALE THREAD SHANK
3	705-008JKRBF	NUT
4	1301-SB1KJKRBF	SHANK ASSEMBLY