

**CHICAGO FAUCETS**  
 a Geberit company

2100 South Clearwater Drive  
 Des Plaines, IL 60018  
 Phone: 847-803-5000  
 Fax: 847-803-5454  
 www.chicagofaucets.com

**REPAIR PARTS**

FITTING NO.

**1005-ABCP**

SUBMITTED MODEL NO.

ITEM NO.

BY: JAR

DATE: 10-13-11

CHK: *JAR*

REV:

**FOR TECHNICAL ASSISTANCE**  
 1-800-TEC-TRUE (1-800-832-8783)

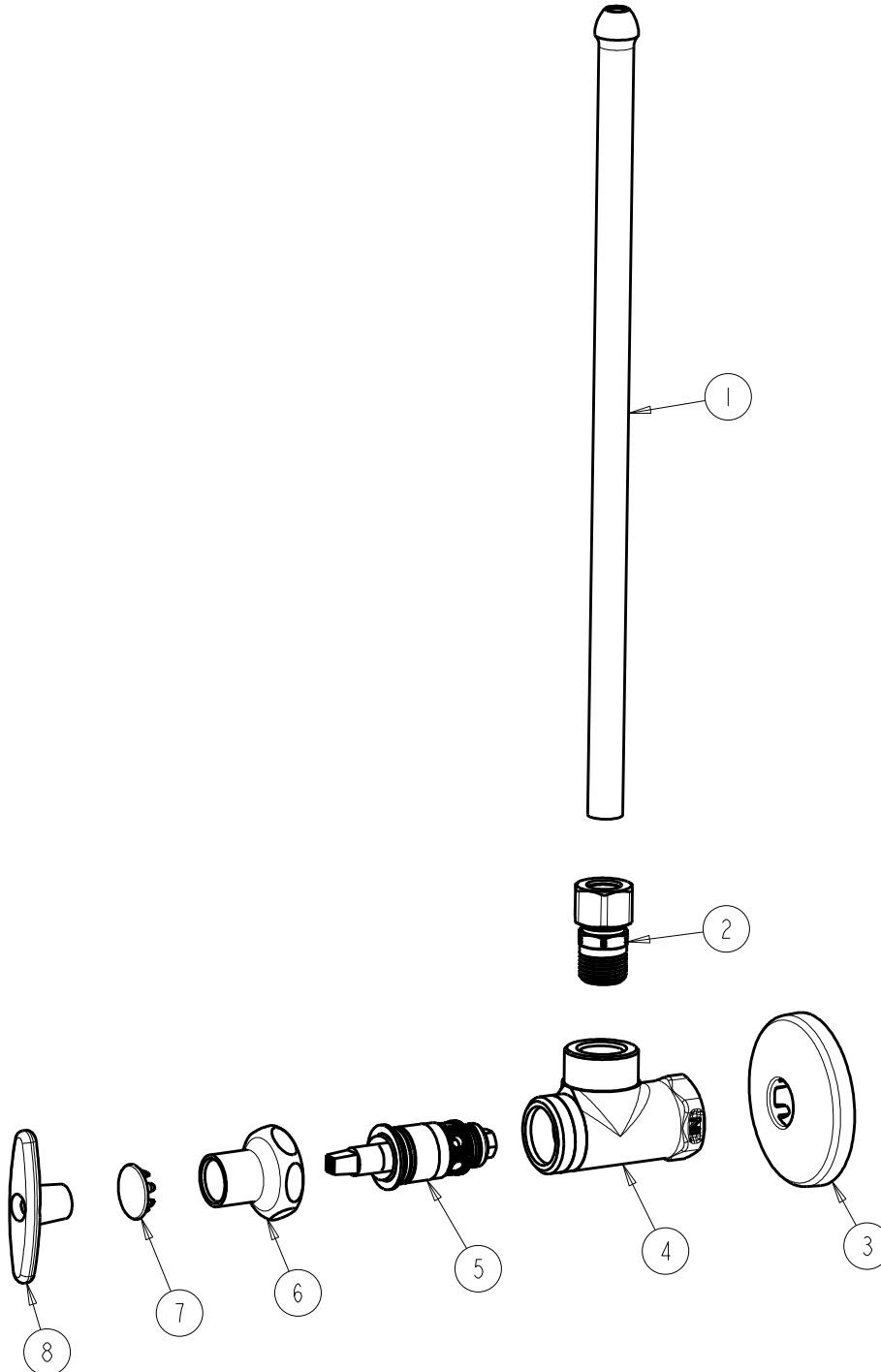

ITEM	PART NO.	DESCRIPTION
1	1003-001JKRCF	FLEXIBLE TUBE 1/2 X 11-15/16
2	1022-006KJKABRCF	COMP. FITTING 1/2 TUBE X 3/8 NPT
3	1003-002JKCP	FLANGE
4	—	VALVE BODY (NOT SOLD SEPERATELY)
5	217-XTLHJKABNF	CARTRIDGE, SLO-COMPRESSION
6	1-246JKCP	NUT, CAP LOOSE KEY 1-1/8-18 UNEF
7	1-144JKCP	BUTTON
8	293-006JKRCF	TEE HANDLE & SCREW